

31st March 2017

Dear Customer,

Anglia have been informed by the supplier Titan Opto that there has been a change to the mold for the parts which are listed below. The following pages detail the height change which has occurred to the part as a result of the new mold.

Part numbers affected by this notification:

SUG15D  
SUG15DT  
SUR15D  
SUR15DT  
SUR15DTB  
SUY15D  
SUY15DT  
SUY15DTB

Anglia operates a strict F.I.F.O system within their Distribution Centre, therefore it may take time for this change to filter through to customer deliveries.

Please ensure this information is circulated to the relevant persons within your organisation.

Yours Sincerely

Anglia

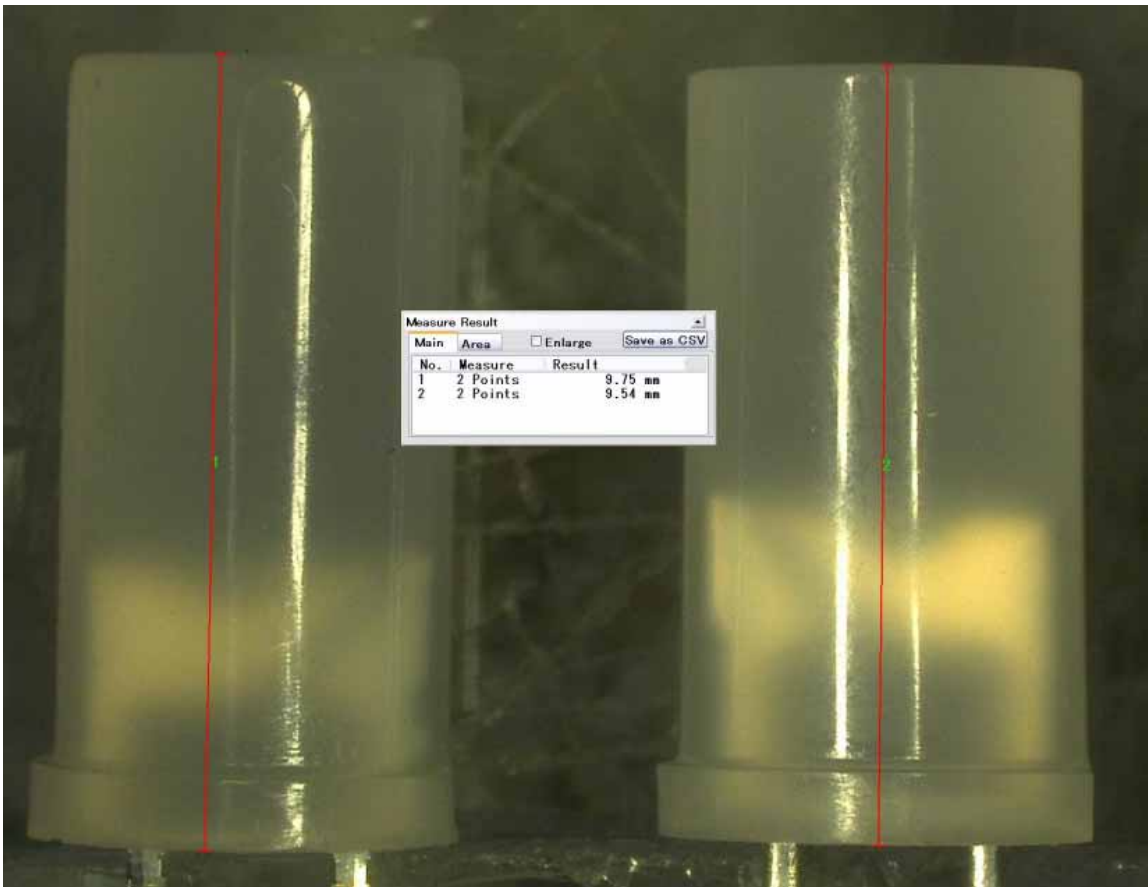
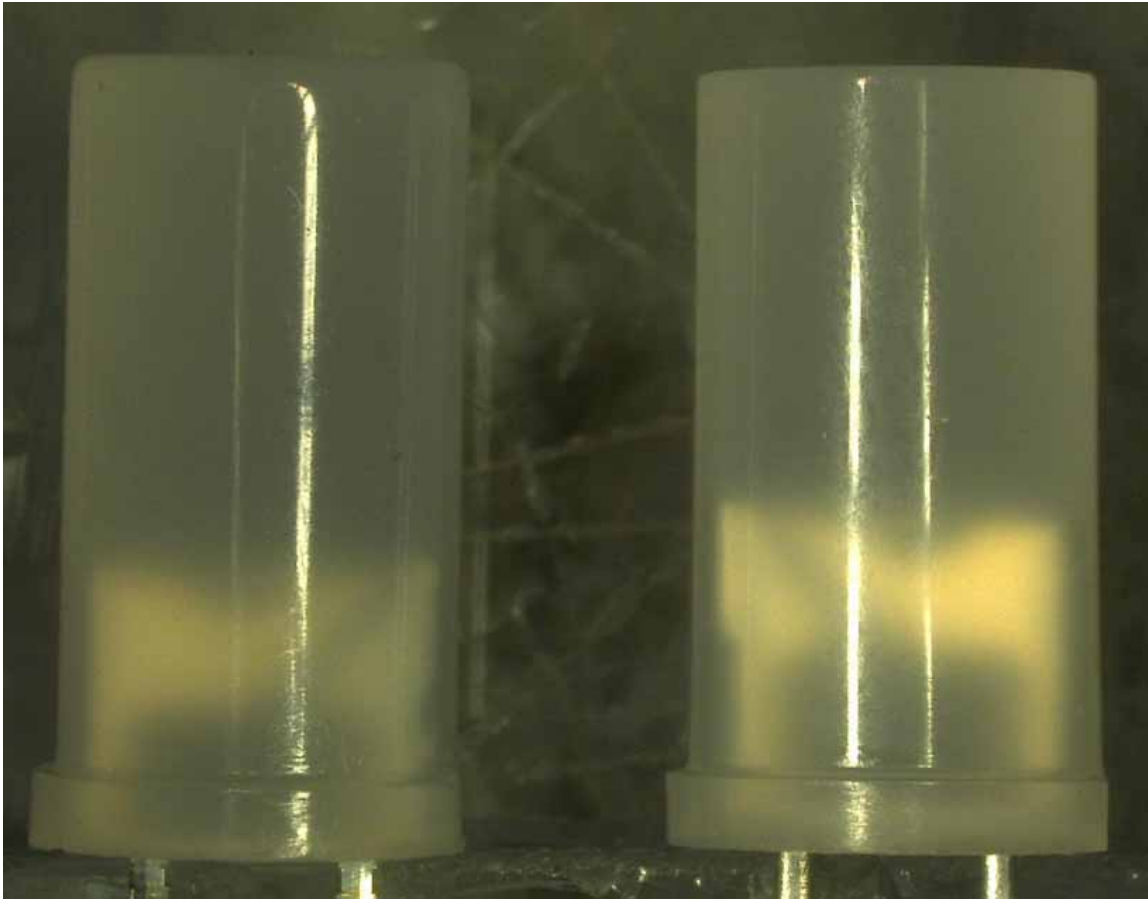

Spec 9.8mm  
Actual height 9.75mm  
Current

Spec 9.6mm  
Actual height 9.54mm  
New

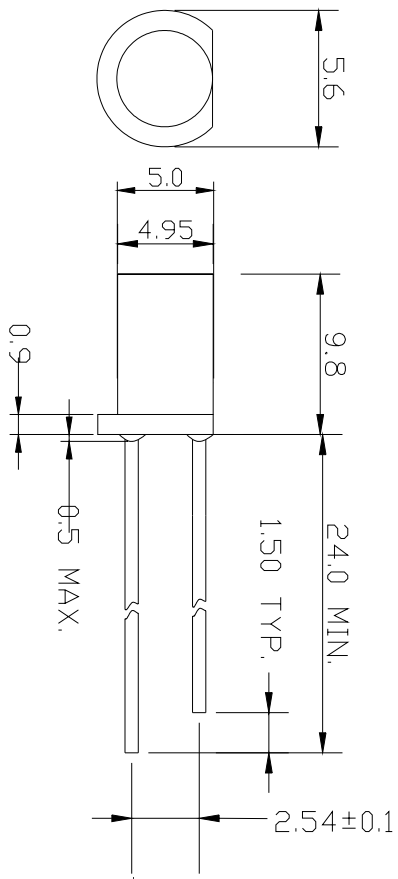

Current mold

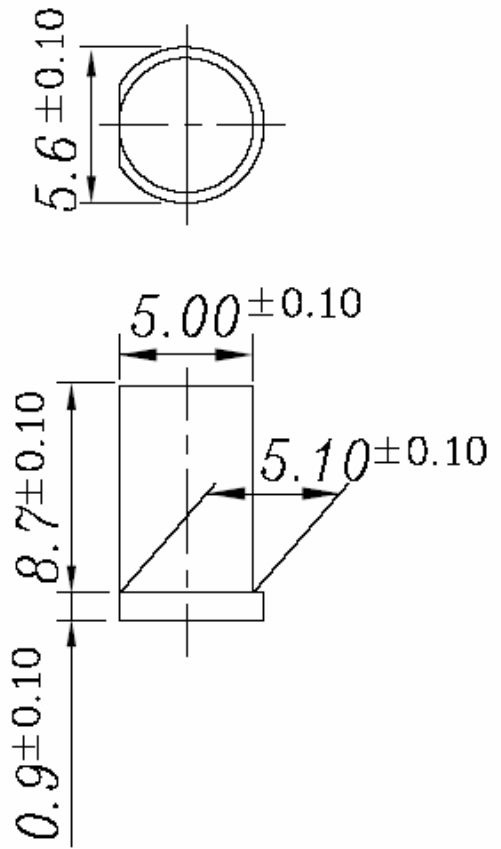

New mold

Epoxy resin height : 9.8mm ( current )

9.6mm ( New )

difference : 0.2mm